

Make Olympic rings

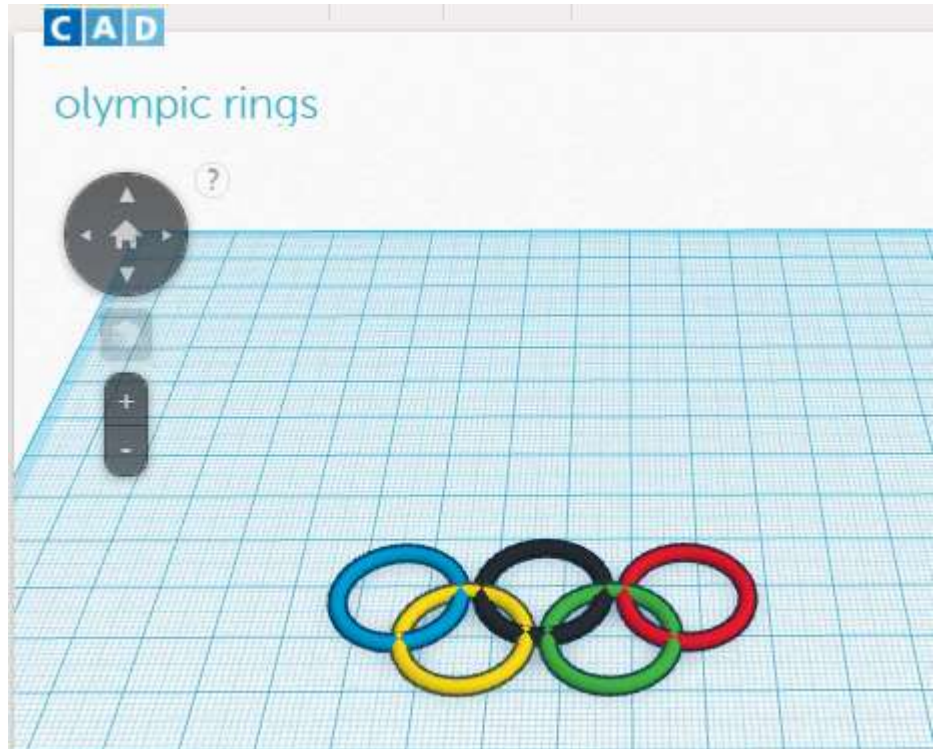

Objectives

- Place objects on workplane
- Position objects accurately
- Change colour of objects
- Save file with name



1. Create new design
2. Select Geometric menu
3. Find *Torus thin*
4. Drag the Torus onto the workplane

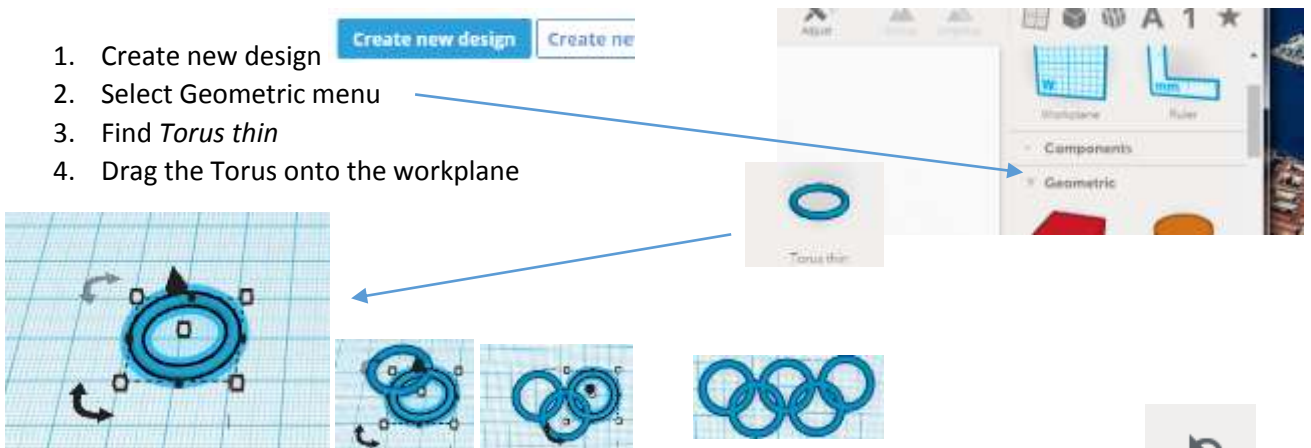

5. Repeat 5 time placing in correct location. Do not adjust size. If size changes use Undo (Ctrl+Z)
6. Use mouse to adjust angle of view, zoom in and out, to get positions.
7. Select one ring, click color, and colour according to Olympic design.
8. Repeat for other rings
9. Select Design in top menu; then Properties



In the properties area change the name of the file to something useful, eg Olympic rings.

